

Woodbine Road, Bolton, BL3 3JH
Offers Over £170,000
Council Tax Band: A



This beautifully presented 3-bedroom terraced home blends contemporary design with a warm, homely atmosphere. Upon entering, you're welcomed by two spacious reception rooms, each tastefully decorated with modern finishes, perfect for relaxing or entertaining. The open, airy layout allows for natural light to flow seamlessly through the space, enhancing the fresh, modern feel.

The kitchen is fitted with stylish, up-to-date appliances and sleek cabinetry, offering a perfect balance of function and design. Upstairs, you'll find three well-sized bedrooms, each with ample space and storage.

With its modern décor, comfortable living spaces, and a welcoming vibe, this home is ideal for families or professionals looking for style and comfort in a convenient location.

Additional features of the property include Front and Back CCTV and also a boarded loft providing additional storage.

Located just off Morris Green Lane, this property has quick access to local convenience stores and public transport links making it an ideal location for families or professionals.



404 Derby Street, Bolton, BL3 6LS
 01204 589600
 bolton@localagent.co.uk
 www.openhousebolton.co.uk

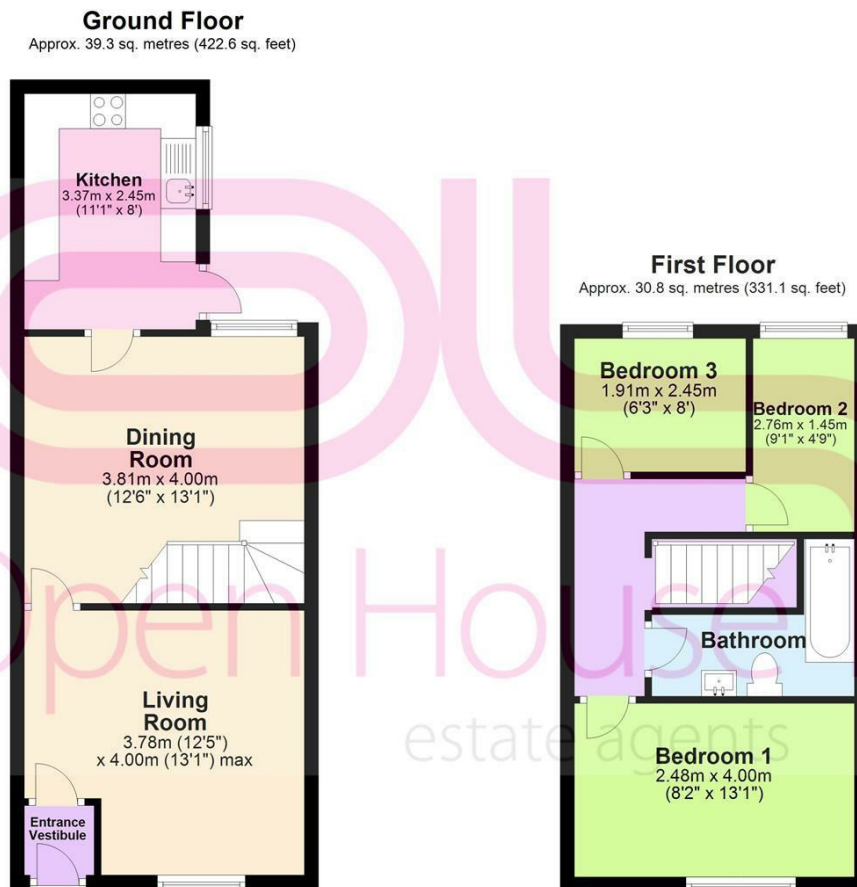

Total area: approx. 70.0 sq. metres (753.7 sq. feet)



Energy Efficiency Rating		
	Current	Potential
Very energy efficient - lower running costs		
(92 plus) A		86
(81-91) B		
(69-80) C		
(55-68) D	68	
(39-54) E		
(21-38) F		
(1-20) G		
Not energy efficient - higher running costs		
England & Wales	EU Directive 2002/91/EC	